

## MX31 Series

### MANUAL, AUTO RESET or MODIFIED CIRCUIT PROTECTOR

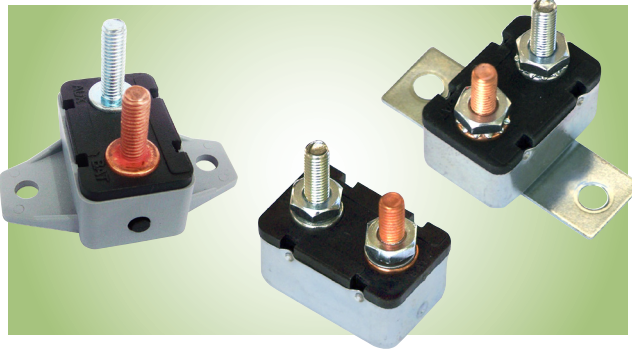

MX31 Series are ruggedly designed automatic and manual reset circuit protectors for demanding applications within the automotive, marine and lawn-and-garden industries, to name just a few.

The MX31 is a low-voltage breaker which operates on the "snap-action" bi-metallic element principle. When an overload reaches the calibrated trip point of the bi-metal element, the contacts snap open, disconnecting the load.



PELCO COMPONENT TECHNOLOGIES • 855 227 3526

#### EXAMPLES OF MX31 SERIES APPLICATIONS include:

- Boats and Marine Equipment
  - Road and Construction Equipment
  - Fire and Emergency Equipment
  - Lawn and Garden Equipment
  - Recreational Vehicles
  - Battery Chargers
  - Buses
  - Trolling Motors
  - Trucks
- ...and many more

The reset button on the manual version pops out, thus providing a visual trip indication, and the circuit remains disconnected until manually reset.

The auto reset version resets itself without visual indication.

Multiple mounting options are available, offering a wide range of applications.

## SPECIFICATIONS

#### ■ Trip Time vs. Overload at 25°C

- At 100% of rated current: no trip
- At 135% of rated current: trip within 1 hour
- At 200% of rated current: trip within 5 to 35 seconds

#### ■ Current and Voltage Ratings

5A–50 A, 12VDC/24VDC

#### ■ Interrupt Capacity

- 5A–10A / 24VDC, 100A
- 11A–15A / 24VDC, 150A
- 16A–20A / 24VDC, 200A
- 21A–30A / 24VDC, 300A
- 31A–40A / 24VDC, 400A
- 41A–50A / 24VDC, 500A

#### ■ Resettable Overload Capacity

10 times rated current

#### ■ Dielectric Strength

1800VAC / 1 minute

#### ■ Insulation Resistance

> 100MΩ

#### ■ Reference Documents

SAE Standard J553 (Type I II III)

#### ■ Operating Temperature

-23°C to 65°C

#### ■ Storage Temperature

-29°C to 93°C

## TRIP TIME CURVE

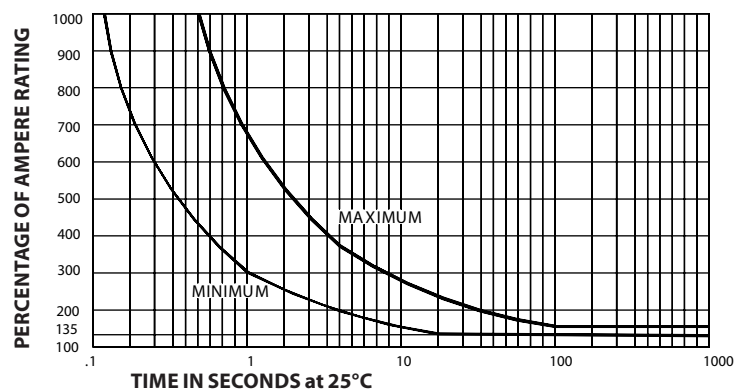

**DIMENSIONS in mm**

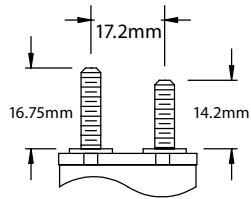

**1** Two 10-32 Studs;  
 .66 (aux); .56 (bat)

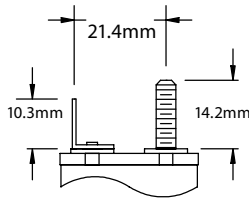

**2** One .250 QC (aux);  
 One 10-32 Stud (bat)

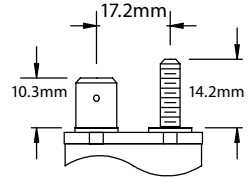

**3** Double .250 QC (aux);  
 One 10-32 Stud (bat)

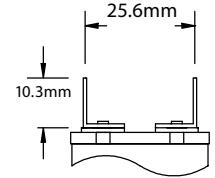

**4** Two .250 QC;  
 (aux & bat)

**TERMINAL OPTIONS**

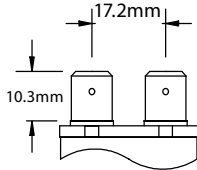

**5** Two Double .250 QC  
 (aux & bat)

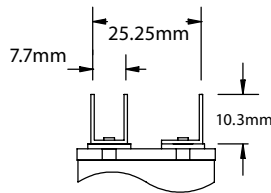

**6** Double .250 QC (aux);  
 Single .250 QC (bat)

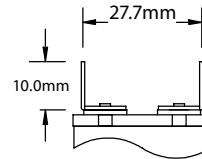

**7** Two .187 QC  
 (aux & bat)

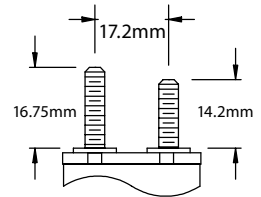

**8** Two 10-32 Studs;  
 .66 (aux); .56 (bat)

**BRACKET OPTIONS**

Metal brackets shown.  
 Consult factory for plastic  
 bracket dimensions.

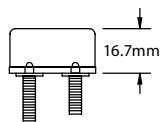
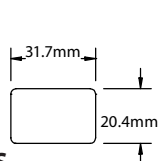

No Bracket

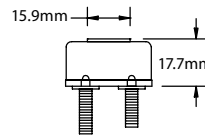
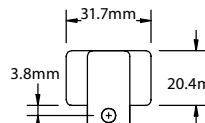

01 Bracket

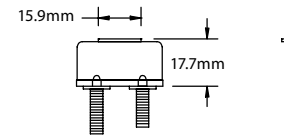
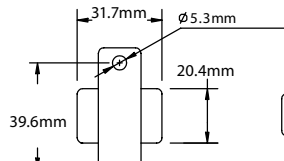

02 Bracket

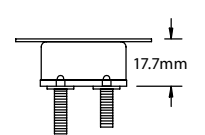
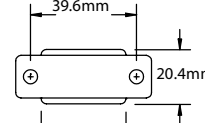

03 Bracket

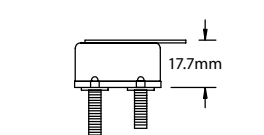
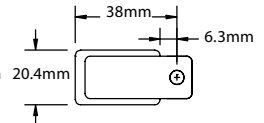

04 Bracket

**OPTIONS SELECTION**

Series	Amps select by number	Volts select by letter	Terminals select by number	Actuator select by letter	Mounting select by number
<b>MX31</b>  Manual or Auto Reset or Modified Circuit Protectors	<b>050</b> 5A	<b>A</b> 12/24VDC	<b>1</b> Two #10-32 Studs (copper/zinc)	<b>A</b> Automatic Reset Type I <b>B</b> Manual Reset Type III <b>C</b> Modified Type II	<b>0</b> No Bracket
	<b>100</b> 10A		<b>2</b> One .250 QC / One #10-32 Stud		<b>1</b> 01 Bracket
	<b>150</b> 15A		<b>3</b> Double .250 QC / One #10-32 Stud		<b>2</b> 02 Bracket
	<b>200</b> 20A		<b>4</b> Two .250 QC		<b>3</b> 03 Bracket
	<b>500</b> 50A		<b>5</b> Two Double .250 QC		<b>4</b> 04 Bracket
			<b>6</b> Double .250 QC / Single .250 QC		<b>5</b> Tie Wrap
	<b>7</b> Two .187 QC	<b>6</b> Special			
	<b>8</b> Two #10-32 Zinc Studs				
	<b>9</b> Two #10-32 Same Length .56"				
					<b>Base Material</b> select by letter
					<b>A</b> Metal <b>B</b> Plastic

Example: **MX31 150 A 5 B 0 B**

MX31, 15Amps, 12/24VoltsDC,

Two double .250 QC terminals, Manual reset, No bracket, Plastic base